

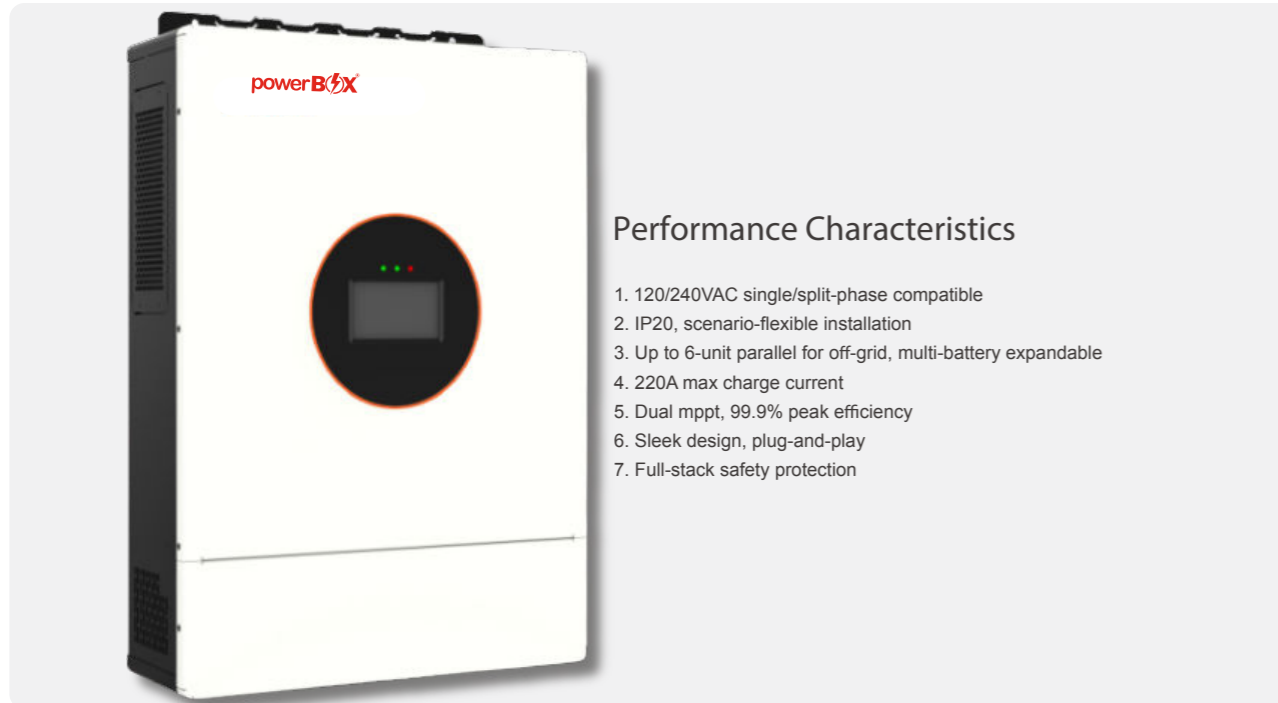

5/6/7/8/10/12 kW Single Phase / Split Phase 120VAC/240VAC

5/6/7/8/10/12 kW Single Phase / Split Phase 120VAC/240VAC



HELIOS LT low voltage split phase off-grid solar inverter delivers robust power management for residential and light commercial applications throughout the Americas. Engineered for 120V/240V single/split-phase systems, it supports flexible configurations with up to 6-unit parallel operation for scalable off-grid or backup power. Featuring dual MPPT channels and 220A max charge current, it maximizes solar harvest and battery efficiency. The IP20-rated design ensures reliable performance in diverse installations, while integrated safety protocols offer grid/off-grid resilience. Ideal for energy independence in homes, farms, and small businesses.

Application Diagram

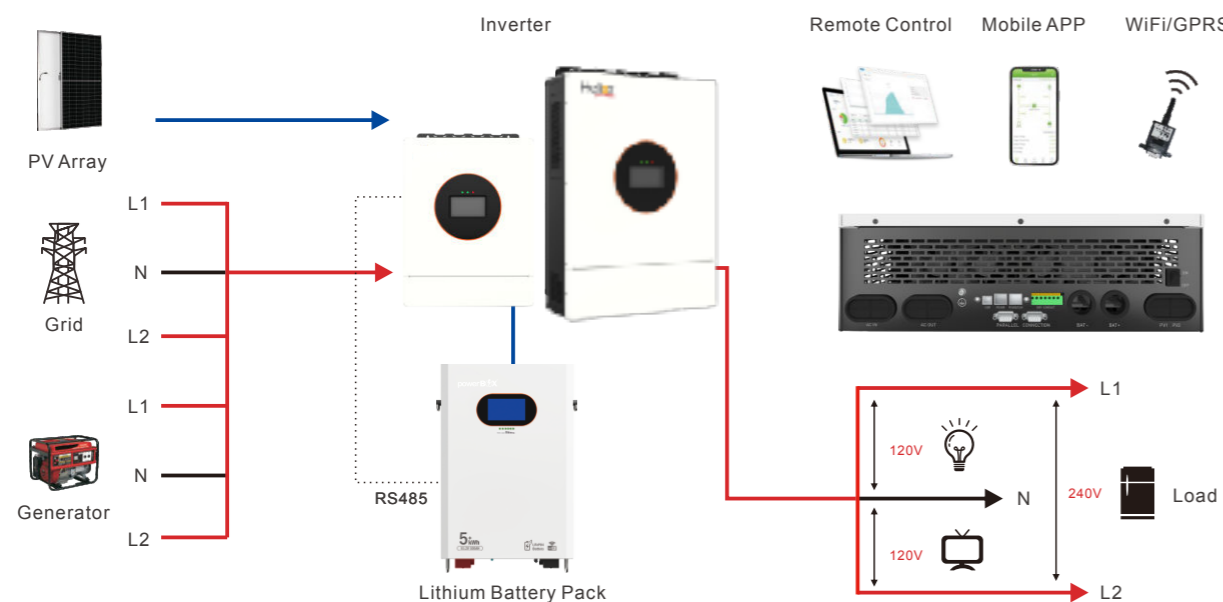

Technical Specifications

Inverter Output						
Rated Output Power	5000W	6000W	7000W	8000W	10000W	12000W
Max Peak Power	10000W	12000W	14000W	16000W	20000W	24000W
Rated Output Voltage	120V, Single-Phase /240V, Split-Phase					
Motor Loading Capacity	4.8HP		5HP		6HP	
Rated Frequency	50/60Hz					
Output Waveform	Pure Sine Wave					
Switching Time	Typical value: 10ms, Max value for single machine: 20ms, Max value for parallel machines: 30ms				10ms	
Number of Parallel Units	6					
Battery						
Battery type	Lithium-ion battery/Lead-acid battery/User-defined					
Rated Battery Voltage	48V					
Voltage Range	40~60V					
Max Solar Charging Current	120A	120A	120A	180A	200A	220A
Max Mains/Generator Charging Current	100A	100A	100A	100A	120A	140A
Max Hybrid Charging Current	120A	120A	120A	180A	200A	220A
PV Input						
Number of MPPT Routes	1			2		
Max Input Power	7500W	9000W	10500W	7500W+7500W		9000W+9000W
Max Input Current	27A			22A+22A		
Max Open-Circuit Voltage	500V			500V+500V		
MPPT Operating Voltage Range	125~425V					
Utility / Generator Input						
Input Voltage Range	90V~140V			90~275V		
Input Frequency Range	60/55~65Hz			50/60Hz		
Bypass Overload Current	40A			63A		
Efficiency						
MPPT Tracking Efficiency	99.90%					
Max Efficiency of Battery Inversion	93%			92%		
General						
Cabinet Size (WxHxDmm)	472×365×130			450×620×142		
Weight (Kg)	15			27		
Protection Level	IP20					
Operating Temperature Range	-10-55 , >45°C Derating					
Noise	≤ 45dB			<60dB		
Cooling Method	Intelligent Air Cooling					
Communication						
Communication Method	Wi-Fi/Bluetooth /GPRS/RS485/CAN/USB/Dry contact/4G (optional)					